

WORKING MECHANISM OF SELF-SEALING VALVE

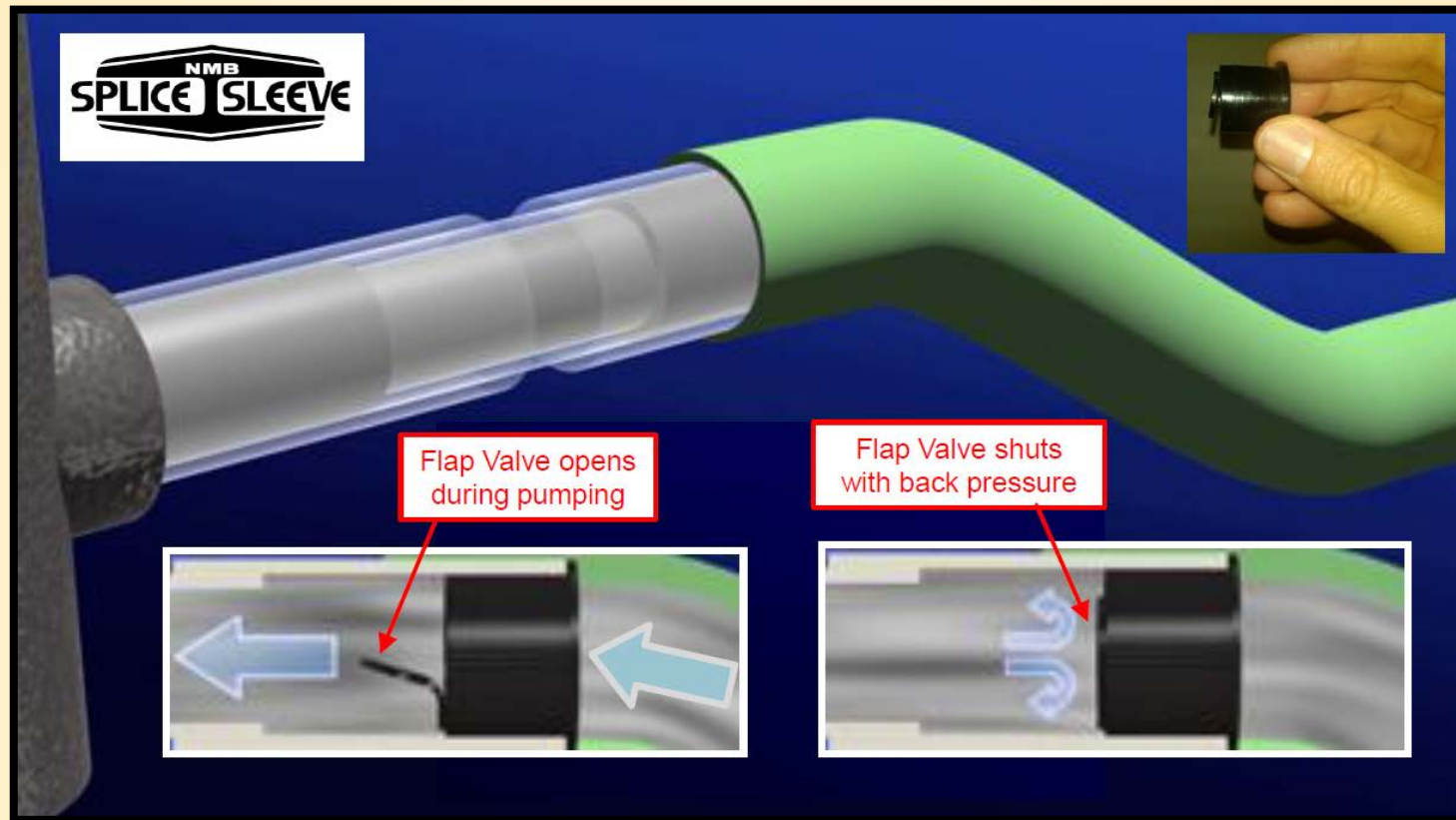

- ✓ Inserts into PVC grout inlet tube.
- ✓ Flap opens while pumping, then closes when grouting stops, preventing backflow and automatically sealing off the tube.
- ✓ Once grout stiffens, remove, clean and reuse.
- ✓ Saves time with plugs and prevents spills, waste and cleanup.
- ✓ **It is recommended to start pumping slowly, especially while using self-sealing valve to avoid clogging, which subsequently can be increased a little bit once a smooth grout flow is confirmed.**

WORKING MECHANISM OF STOPPER WITH INDICATOR

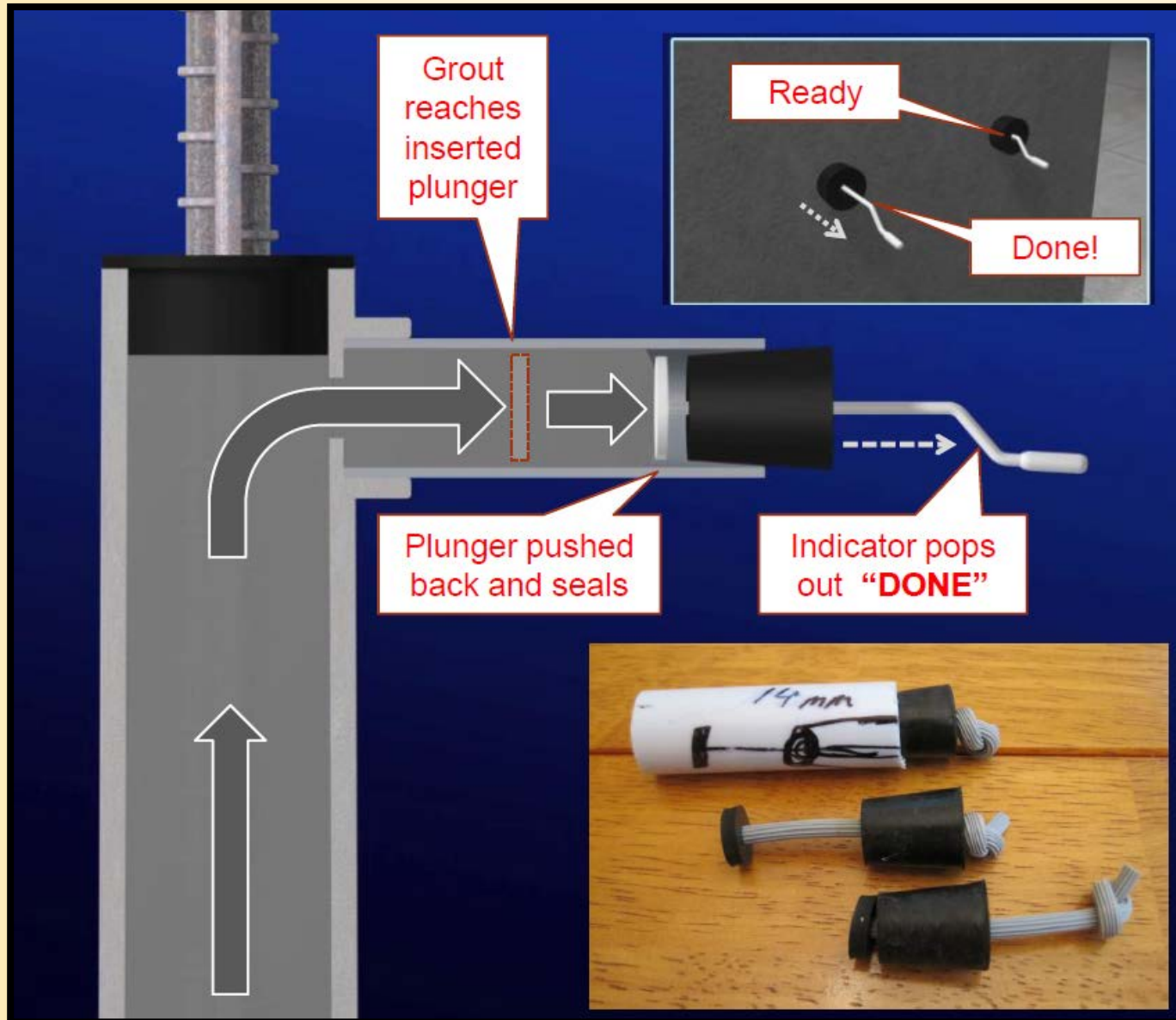

✂ It allows air and water to pass but when solid grout arrives it pushes the plunger back against the Stopper sealing off the tube automatically.

✂ Once grout stiffens, remove - clean – reuse.

✂ Saves time, catching cups & plugs, prevents spills & cleanup.

✂ Combined with the Self Sealing Valve, one person can grout.